

Badham Library Guide

Badham Library specialises in information for all areas of the life sciences including agriculture, biological sciences, animal and veterinary sciences. For a guide to other subjects and libraries check <http://www.library.usyd.edu.au>

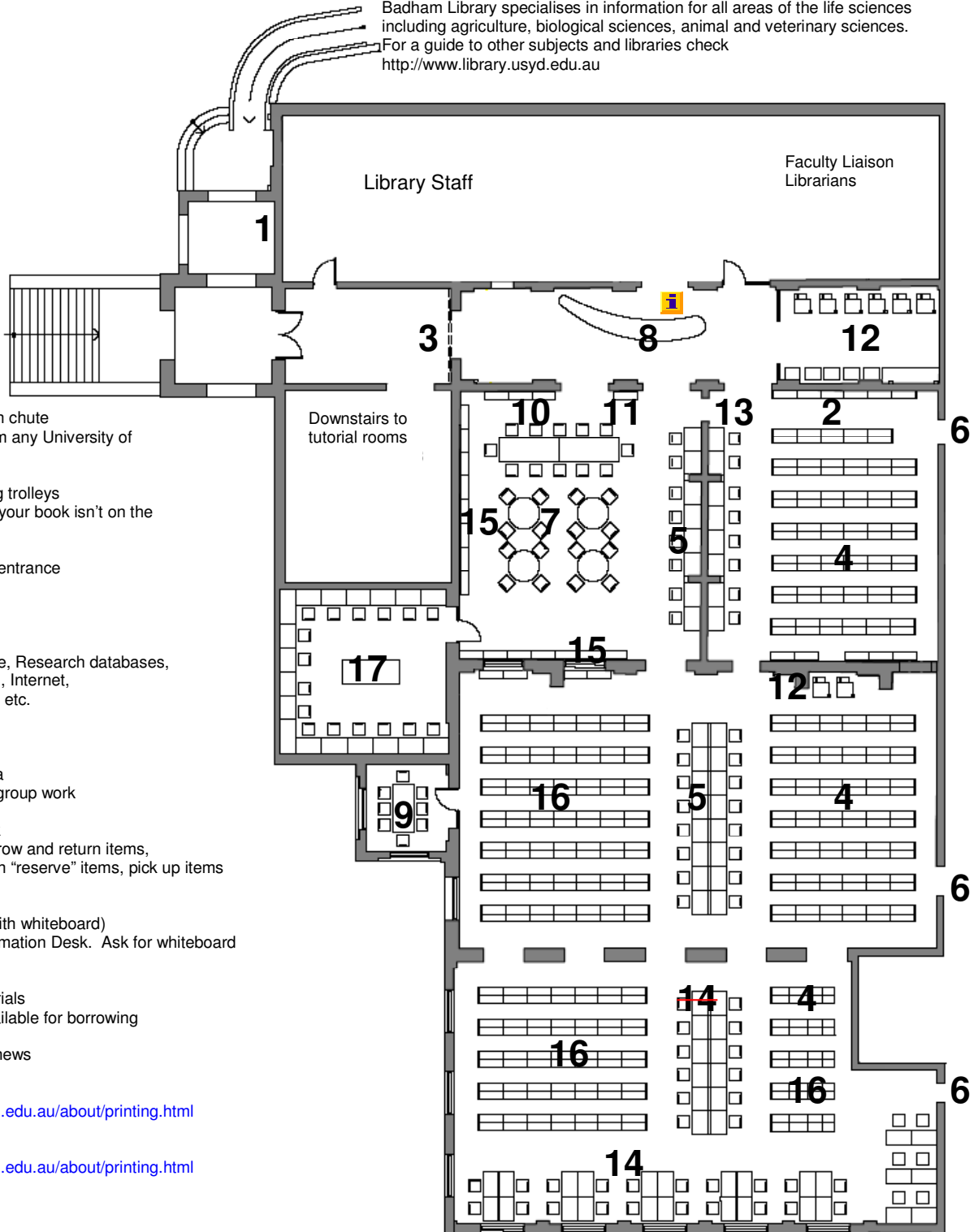

1. After hours return chute
Return items from any University of Sydney Library
2. Awaiting shelving trolleys
Look here first if your book isn't on the shelf
3. Badham Library entrance
4. Book shelves
5. Computers
Library Catalogue, Research databases, Electronic serials, Internet, Word processing etc.
6. Emergency exit
7. Group study area
Large tables for group work
8. Information Desk
Ask for help, borrow and return items, borrow and return "reserve" items, pick up items on "hold"
9. Meeting room (with whiteboard)
Book at the Information Desk. Ask for whiteboard markers
10. New books & serials
Latest books available for borrowing
11. Noticeboard for news
12. Photocopying
www.library.usyd.edu.au/about/printing.html
13. Printing
www.library.usyd.edu.au/about/printing.html
14. Quiet study area
15. Reference shelves
Encyclopedias and dictionaries
16. Serials shelves
Many serials are in electronic form. Check the Catalogue for details
17. Troughton room
Lots of computers. Available when not booked for training.

Turn over page for more information